

# 四角支柱

## H-300

- 許容荷重…… 196kN (20t)
- 質 量…… 62.5kg

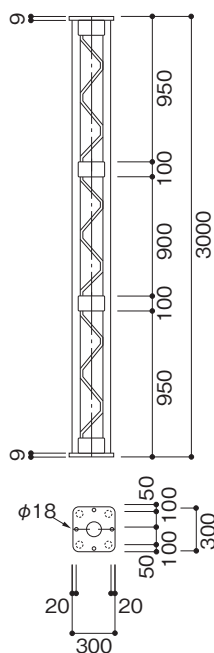

## H-225

- 許容荷重…… 196kN (20t)
- 質 量…… 48.7kg

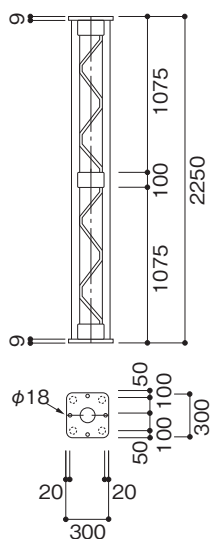

## H-200

- 許容荷重…… 196kN (20t)
- 質 量…… 45.8kg

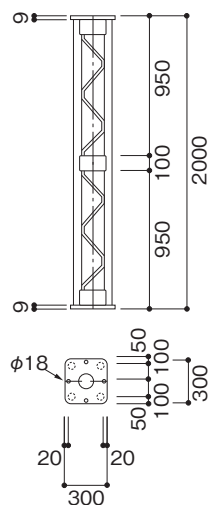

## H-125

- 許容荷重…… 196kN (20t)
- 質 量…… 32.8kg

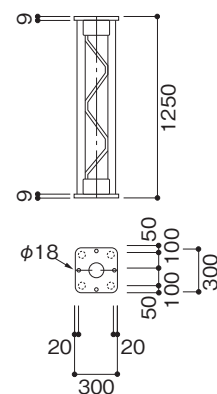

## H-65

- 許容荷重…… 196kN (20t)
- 質 量…… 23.5kg

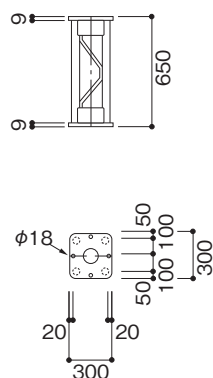

## J-58

- 質 量…… 30.5kg

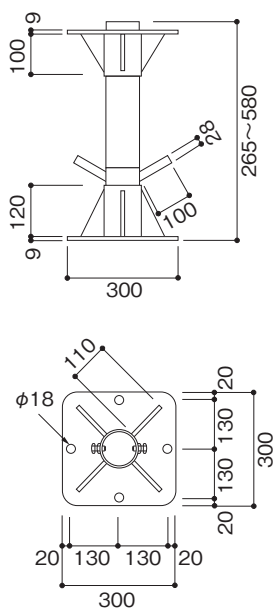

## U-31

- 質 量…… 11.2kg

