

# OK サポート

## 移動装置

●許容荷重…… 6,865N (700kg)

移動装置施工例

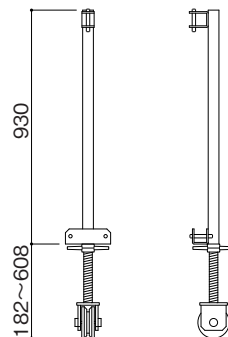
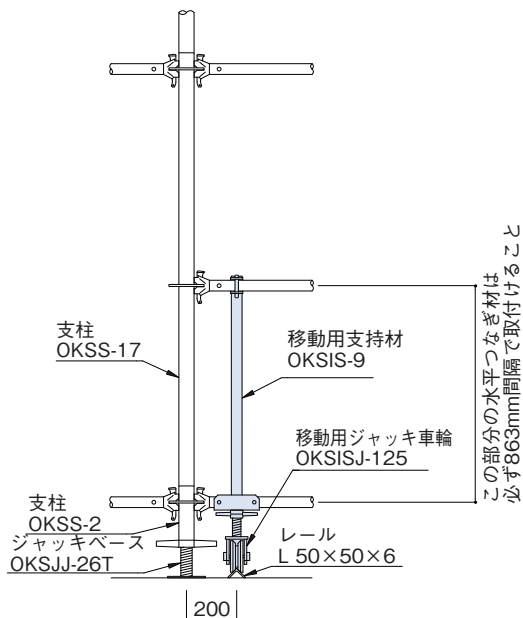

移動部材 OKSIS (15.5kg)

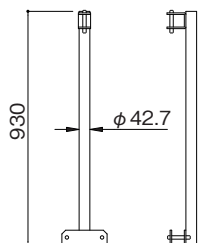

支持材 OKSIS-9 (5.0kg)

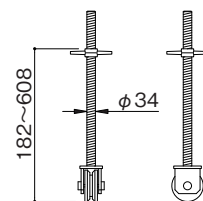

ジャッキ車輪 OKSISJ-125 (10.5kg)

## フサギ板

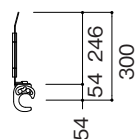
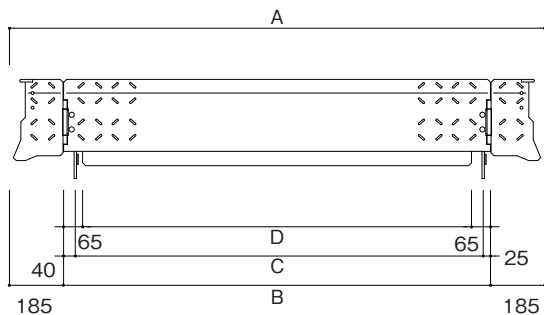

記号	A mm	B mm	C mm	D mm	質量 kg
OKW-3018	1829	1549	1394	1329	11.6
OKW-3015	1524	1154	1089	1024	10.0
OKW-3012	1219	849	784	719	8.4
OKW-3009	914	544	479	414	6.7
OKW-3006	610	240	175	110	5.1

フサギ板 割付例

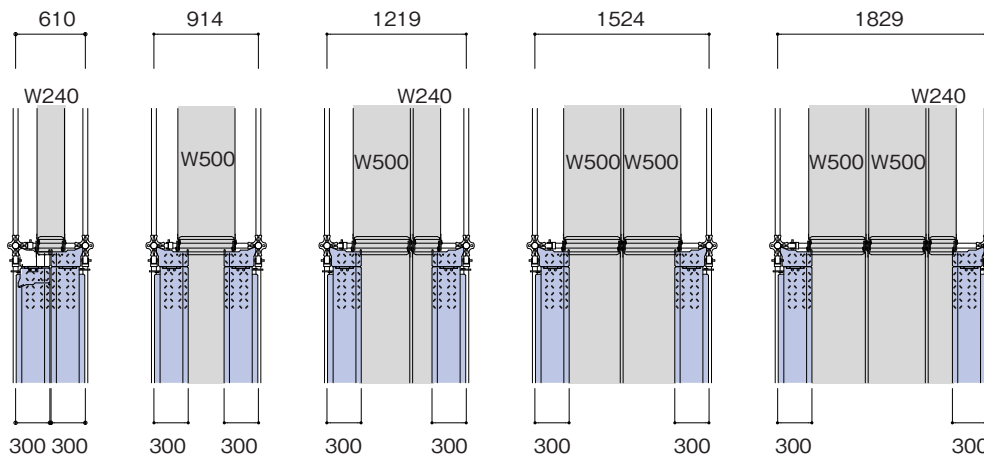

OK サポート